

figure **918**

ends threaded

 **AIR - RELEASE VALVE zAIR**



| body material | nominal pressure | nominal diameter | max. temperature |
|---------------------|------------------|------------------|------------------|
| A grey cast iron | C 16 bar | DN 25 | 100°C |

FEATURES

- high tightness
- compact settlement
- environment-friendly
- no maintenance

APPLICATION

- de-aeration of water pipeline
- montage in the highest point of the pipeline

Data given can be changed without notice.

Edition 12/2016



figure **918**
ends threaded

MATERIALS

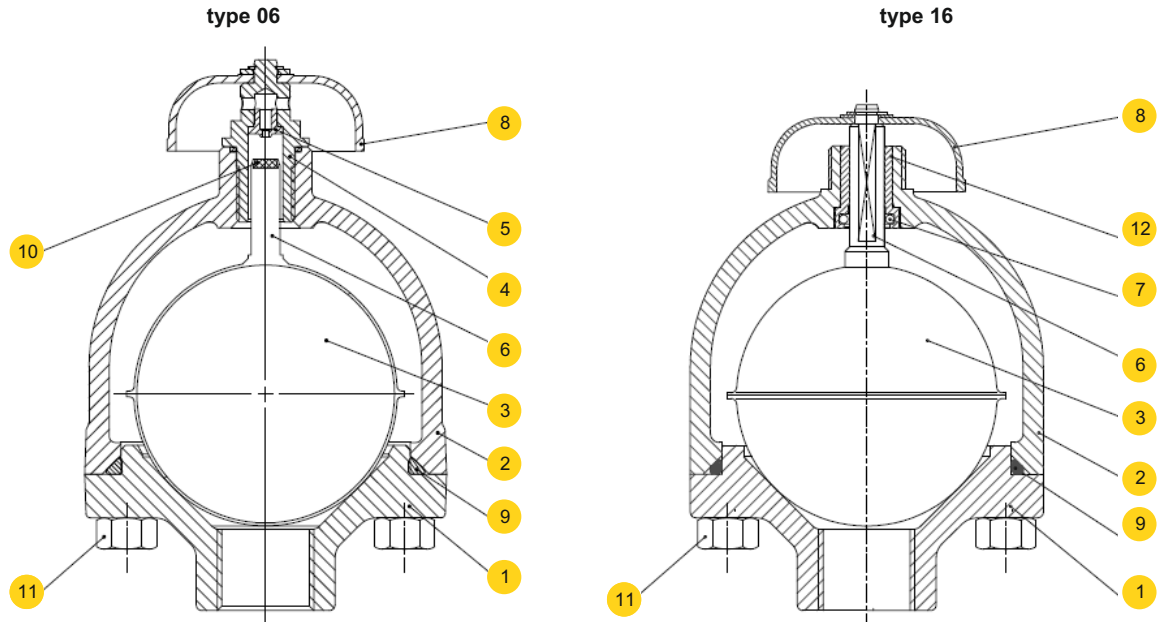

| body material | | A | |
|------------------|--------------|------------------------|------------------------|
| type | | 06 | 16 |
| 1 | body | EN – GJL-250 JL1040 | |
| 2 | bonnet | EN – GJL-250 JL1040 | |
| 3 | float | X5CrNi 18-10 1.4301 | |
| 4 | screw plug | X20Cr13 1.4021 | ----- |
| 5 | nozzle | CuZn40Mn1,5 | ----- |
| 6 | stem | X5CrNi 18-10 1.4301 | |
| 7 | packing ring | ----- | EPDM |
| 8 | cup | ABS | |
| 9 | packing ring | EPDM | |
| 10 | float gasket | EPDM | |
| 11 | bolt | 8.8 - A2A | |
| 12 | sleeve | ----- | X5CrNi 18-10 1.4301 |
| max. temperature | | 100°C | |

Data given can be changed without notice.

Edition 12/2016



figure **918**
ends threaded

DIMENSIONS

type 06

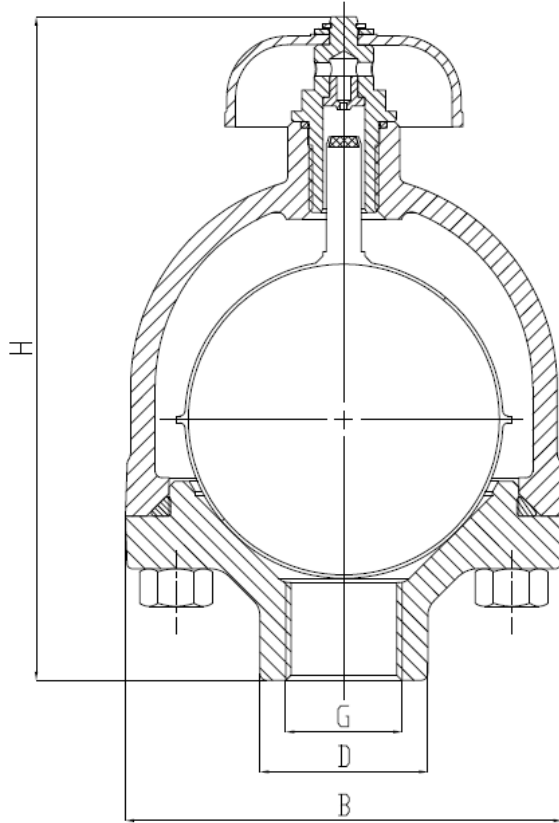

type 16

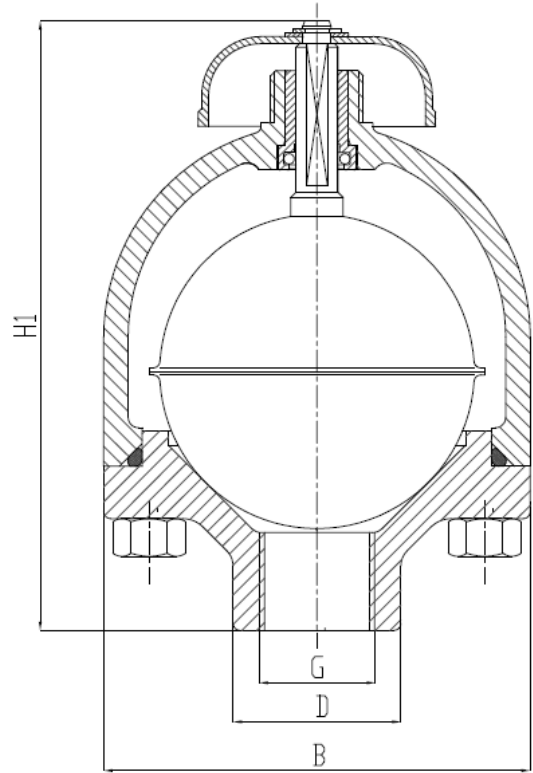

| | PN 16 (type 06, 16) | | | | PN 16 (type 06) | PN 16 (type 16) |
|----|---------------------|----|----|-----|-----------------|-----------------|
| | B | D | G | | H | H1 |
| | kg | | | | mm | |
| 25 | 122 | 48 | 1" | 4,7 | 190 | 185 |

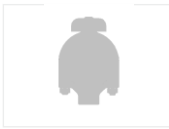
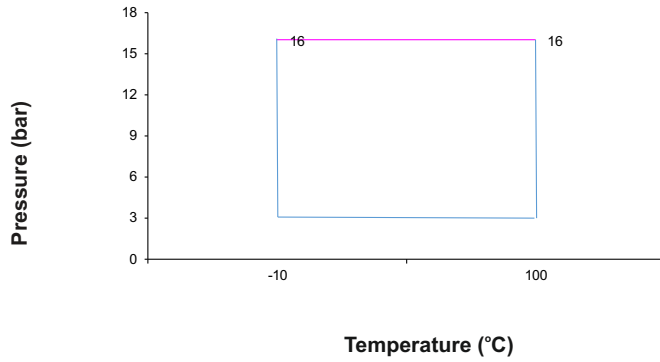
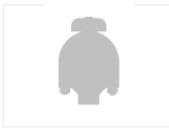

figure **918**
ends threaded

PRESSURE-TEMPERATURE RATINGS



Allowed working conditions range
PN 16 EN-GJL-250



| | |
|--------|------------|
| figure | 918 |
| ends | threaded |

TYPES

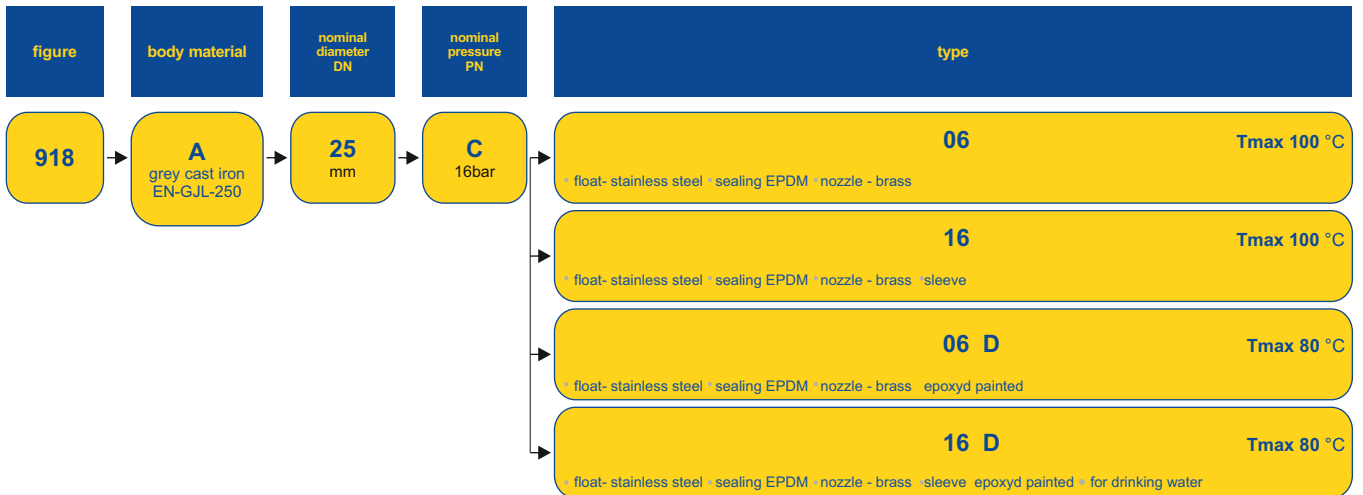

ORDERING

To place an order please use our product number (index)



ORDER EXAMPLE

