



figure

495

ends
formwafer type
straight**BUTTERFLY VALVE zBUT**

body material	nominal pressure	nominal diameter	max. temperature
A grey cast iron	C 16 bar	DN 40-150	110°C
	B 10 bar	DN 200-250	

**FEATURES**

- high tightness
- seat materials EPDM/NBR
- central disc bearing
- environment-friendly

APPLICATION *

- cold and cooling water plants
- heating installations
- drinking and domestic water
- waste installations
- shipbuilding industry
- power installations
- vacuum installations

* recommended for system with high speed fluids

Data given can be changed without notice.

Edition 06/2016



figure	495
ends form	wafer type straight

MATERIALS

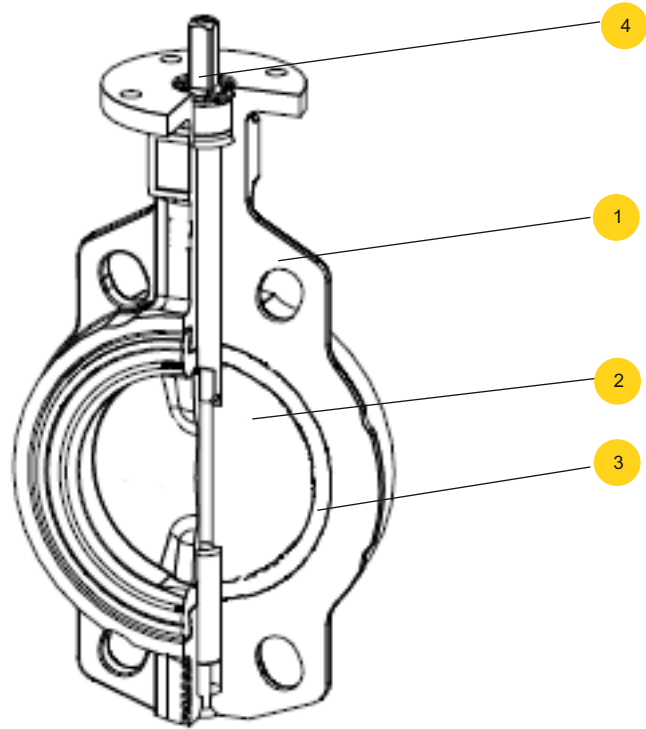

	body material	A
	type	66
1	body	EN-GJL-250 5.1301 (ex.JL 1040) + EPOXY
2	disc	EN-GJS-400-15 5.3106 (ex.JS 1030) + EPOXY
3	seat	EPDM
4	stem	AISI 420
	max. temperature	110°C

Data given can be changed without notice.

Edition 06/2016



figure 495
 ends form wafer type
 form straight

DIMENSIONS

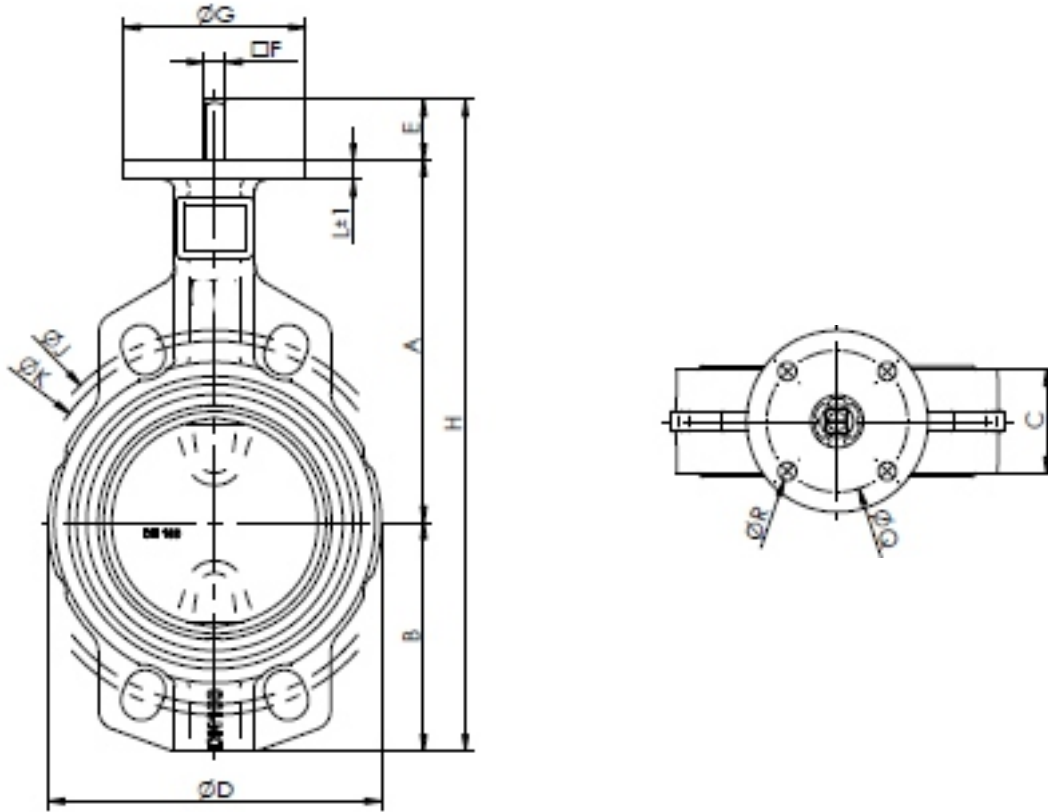

DN		A	B	C	D	E	F	G	H	J	K	L	Q	R		ISO
mm	inch	mm													kg	
40	1 1/2"	132	63	33	76	30	11	90	225	110	94	10	70	4x9	2,12	F-07
50	2"	140	80	43	108	30	11	90	250	125	120,7	10	70	4x9	3,25	F-07
65	2 1/2"	154	90,5	46	123	30	11	90	274,5	145	139,7	10	70	4x9	3,5	F-07
80	3"	160	100	46	137	30	11	90	290	160	162,5	10	70	4x9	3,8	F-07
100	4"	180	113	52	165	30	11	90	323	190,5	180	10	70	4x9	4,8	F-07
125	5"	197	129	56	191	33	14	90	359	215,9	210	12	70	4x9	6,1	F-07
150	6"	210	144,5	56	218	33	14	90	387,5	241,3	240	12	70	4x9	7,4	F-07
200	8"	240	172	60	265	33	14	90	445	298,5	295	12	70	4x9	10,5	F-07
250	10"	282,5	210	68	324	23	22	130	515,5	362	335	14	102	4x12	20,8	F-10

Data given can be changed without notice.

Edition 06/2016



figure	495
ends form	wafer type straight

TYPES

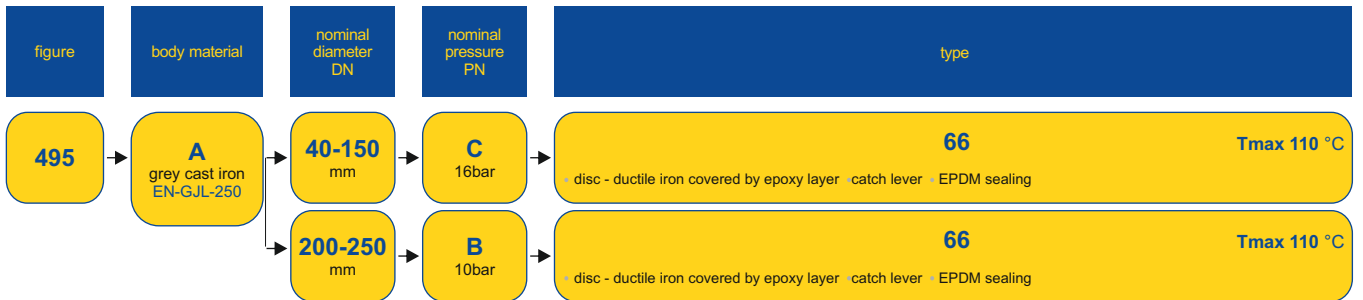

ORDERING

To place an order please use our product number (index)



ORDER EXAMPLE

