



figure

217

ends
formwelded
straight **STOP VALVE zGLO**

body material	nominal pressure	nominal diameter	max temperature
F cast steel	E 40 bar	DN 15-200	450°C
I cast stainless steel	E 40 bar	DN 15-200	400°C



correspond to the pressure equipment directive 2014/68/UE
marking CE for DN≥32

FEATURES

- high tightness (leakproofness class - A acc. to EN - 12266 - 1)
- compact settlement
- environment friendly
- tests acc. to EN - 12266 - 1
- face-to-face dimension according to EN 558 series 1

APPLICATION*

- industry
- shipbuilding industry
- heating
- refrigeration and air conditioning
- glycol
- industrial water
- diathermic oil
- steam
- compressed air
- neutral fluids

* not all of the applications are suitable for all of the executions

Data given can be changed without notice.

Edition 06/2016



figure

217

ends
form

welded
straight

MATERIALS

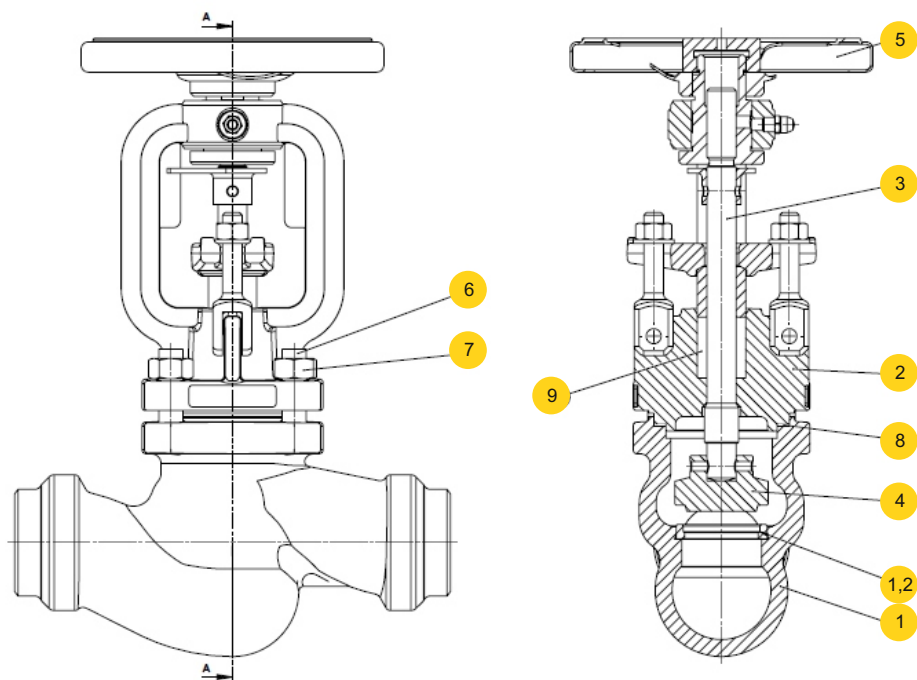

	body material	F	I
	type	01; 04; 31	09; 10; 40
1	body	GP240GH 1.0619	G-X5CrNiMo19-11-2 1.4408
1,2	seat ring	X20Cr13 1.4021	X5CrNiMo17-12-2 1.4401
2	bonnet	GP240GH 1.0619	G-X5CrNiMo19-11-2 1.4408
3	stem	X20Cr13 1.4021	X6CrNiMoTi17-12-2 1.4571
4	disc	X20Cr13 1.4021	X6CrNiMoTi17-12-2 1.4571
5	hand-wheel	steel	
6	stud bolt	24CrMo4	A4-70
7	nut	C35E 1.1181	A4
8	bonnet gasket	graphite+CrNiSt	
9	gland packing	graphite	
	max temperature	450°C	400°C

Data given can be changed without notice.

Edition 06/2016



figure

217

ends
form

welded
straight



ZETKAMA

DIMENSION

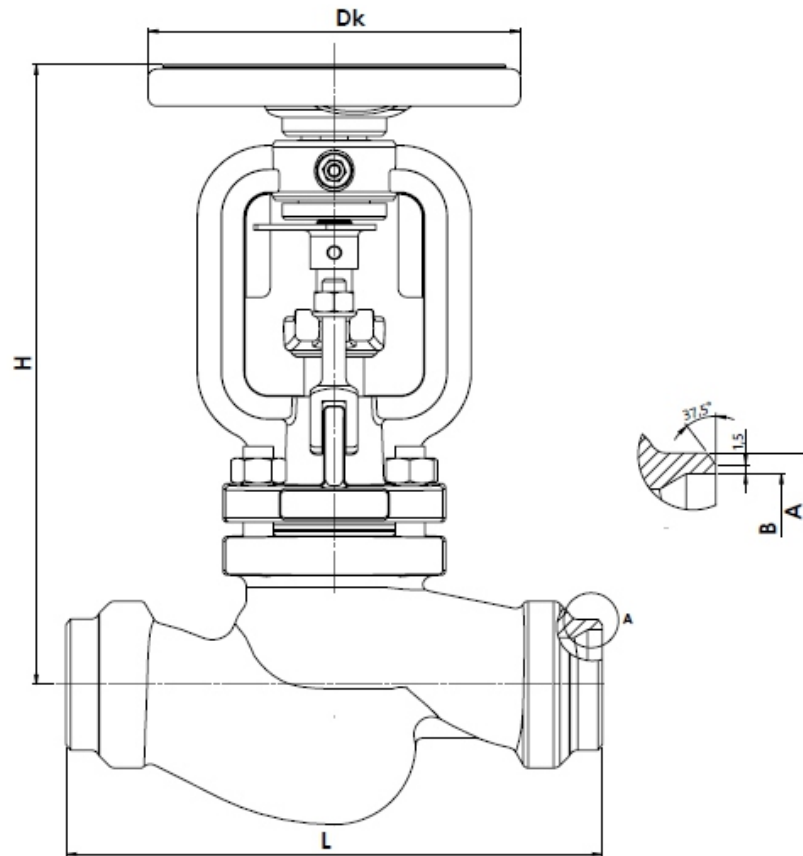

DN	L	H	Dk	A	B	
mm						kg
15	130	205	125	22	17,3	3,2
20	150	205	125	28	22,3	3,4
25	160	205	125	35	28,5	3,9
32	180	210	125	44	37,2	4,3
40	200	250	200	50	43,1	8,2
50	230	250	200	61	54	9,1
65	290	280	250	77	68,9	14,0
80	310	320	250	91	80,9	19,1
100	350	425	300	117	104,3	35,9
125	400	470	300	144	130,7	50,5
150	480	495	400	157,1	172	79
200	600	613	500	223	204,9	158

Data given can be changed without notice.

Edition 06/2016



figure

217

ends
form

welded
straight

PRESSURE-TEMPERATURE RATINGS

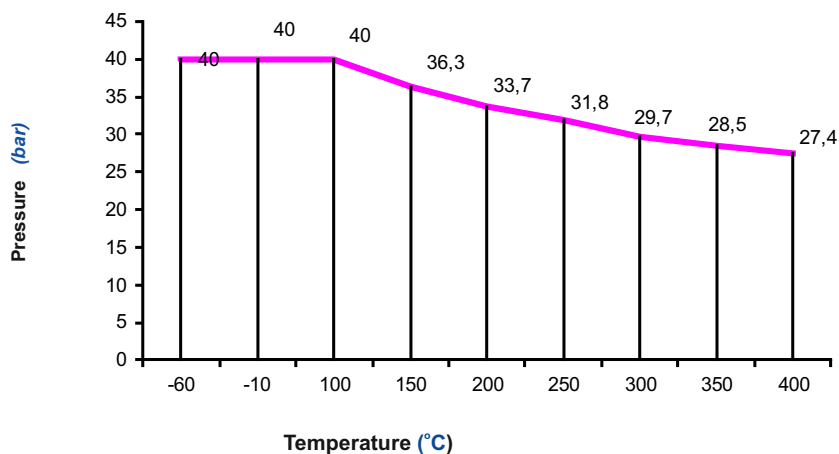
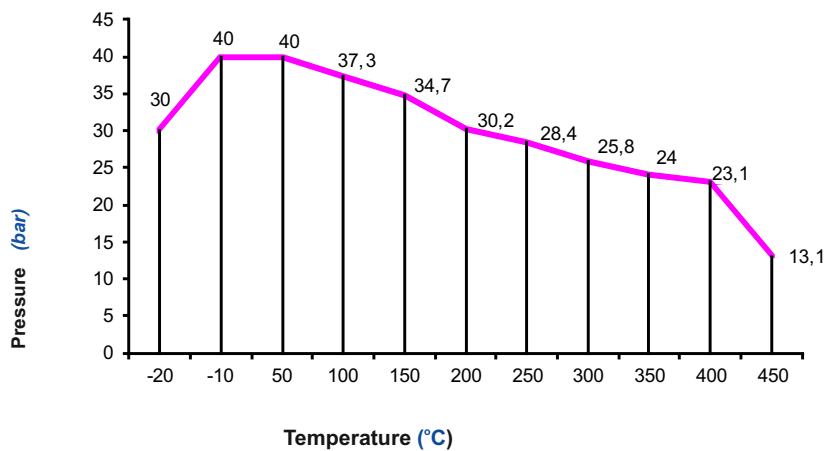



figure	217
ends form	welded straight

TYPES

figure	body material	nominal diameter DN	nominal pressure PN	type
217	F cast steel GP240GH	15-100 mm	E 40bar	01 • stop valve Tmax 450 °C
		125-200 mm	E 40bar	04 • stop valve, balancing disc Tmax 450 °C
		15-200 mm	E 40bar	31 • stop check valve Tmax 450 °C
	I cast stainless steel G-X5CrNiMo 19-11-2	15-100 mm	E 40bar	10 • stop valve Tmax 400 °C
		125-200 mm	E 40bar	09 • stop valve, balancing disc Tmax 400 °C
		15-200 mm	E 40bar	40 • stop check valve Tmax 400 °C

ORDERING

To place an order please use our product number (index)



ORDER EXAMPLE

