



figure	111
ends form	flanged straight

## GATE VALVE zGAT



body material	nominal pressure	nominal diameter	max. Temperature
D nodular cast iron	C 16 bar	DN 40-600*	70°C

\* DN650 - DN800 on inquire



*Hygienic certificate PZH*

### FEATURES

- high tightness (leakproofness class - A acc. EN -12266 - 1)
- face of face dimensions: series 14 acc EN 558-1, F4 acc. to DIN 3202
- flange end connections: EN-1092-2
- fusion bonded epoxy coating RAL 5002
- coating tightness: 300µm
- prepared for actuator mounting

### APPLICATION

- industry
- drinking water
- industrial water
- neutral fluids

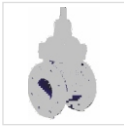

**MATERIALS DN40-300**

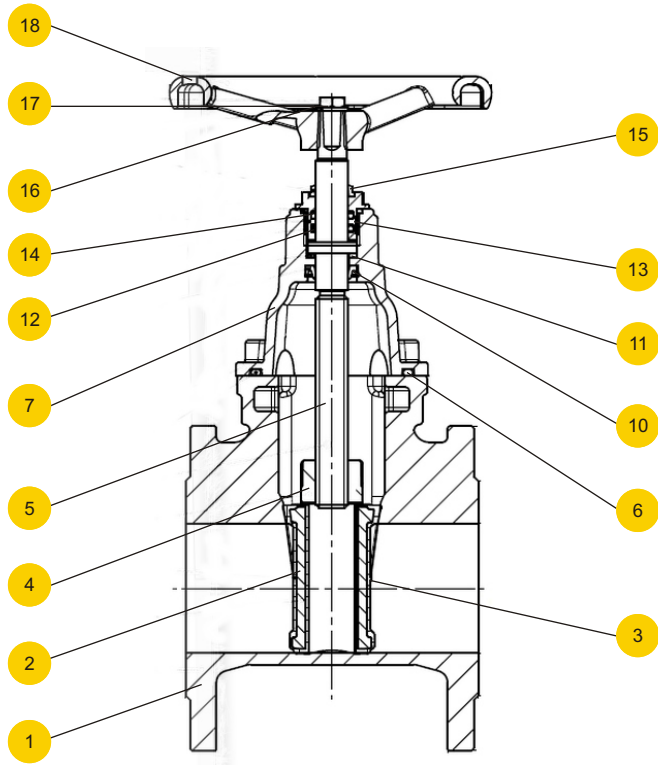
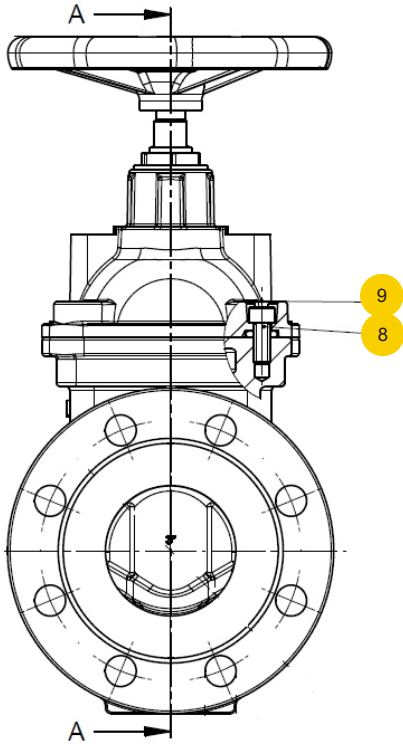

body materials		D
type		57-Y
1	kadtub	EN-GJS-500-7 5.3200 (ex.JS1050)
2	wedge casting	EN-GJS-500-7 5.3200 (ex.JS1050)
3	cover of wedge	EPDM
4	threaded bush	CuZn36Pb2As
5	stem	X20Cr13
6	cover seal	EPDM
7	cover	EN-GJS-500-7 5.3200 (ex.JS1050)8.8
8	bolt	C15, C15R, C15E
9	screw cover cap	Plastic
10	seal	EPDM
11	washer	Nylon
12	o-ring	EPDM
13	thrust bearing	CuZn36Pb2As
14	o-ring	EPDM
15	seal	NBR/EPDM
16	washer	C15, C15R, C15E
17	nut	C15, C15R, C15E
18	hand wheel	EN-GJS-500-7 5.3200 (ex.JS1050)8.8
<b>max. temperature</b>		<b>70°C</b>

Data given can be changed without notice.

Edition 12/2016

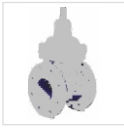

**MATERIALS DN350-600**

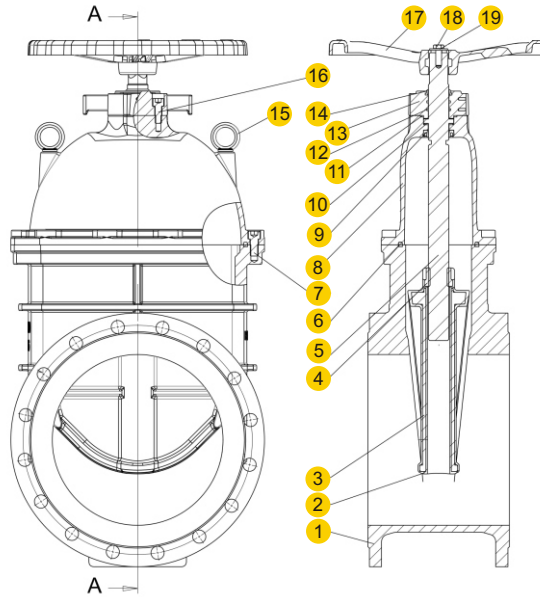

body materials		D
typee		36-Y
1	body	EN-GJS-500-7 5.3200 (ex.JS1050)
2,3	wedge	EN-GJS-500-7 5.3200 (ex.JS1050) / EPDM
4	threaded bush	CuZn36Pb2As
5	stem	X20Cr13
6	cover seal	EPDM
7	bolt	C15, C15R, C15E
8	cover	EN-GJS-500-7 5.3200 (ex.JS1050)
9	seal ring	EPDM
10	stem thrust washer	PA
11	gasket	EPDM
12	o-ring	EPDM
13	gland flanged	EN-GJS-500-7 5.3200 (ex.JS1050)
14	dust guard	EPDM
15	eye bolt	C15, C15R, C15E
16	bolt	C15, C15R, C15E
17	hand wheel	EN-GJS-500-7 5.3200 (ex.JS1050)
18	nut	C15, C15R, C15E
19	washer	C15, C15R, C15E
<b>Max. temperature</b>		<b>70°C</b>

Data given can be changed without notice

Edition 12/2016



**DIMENSIONS**

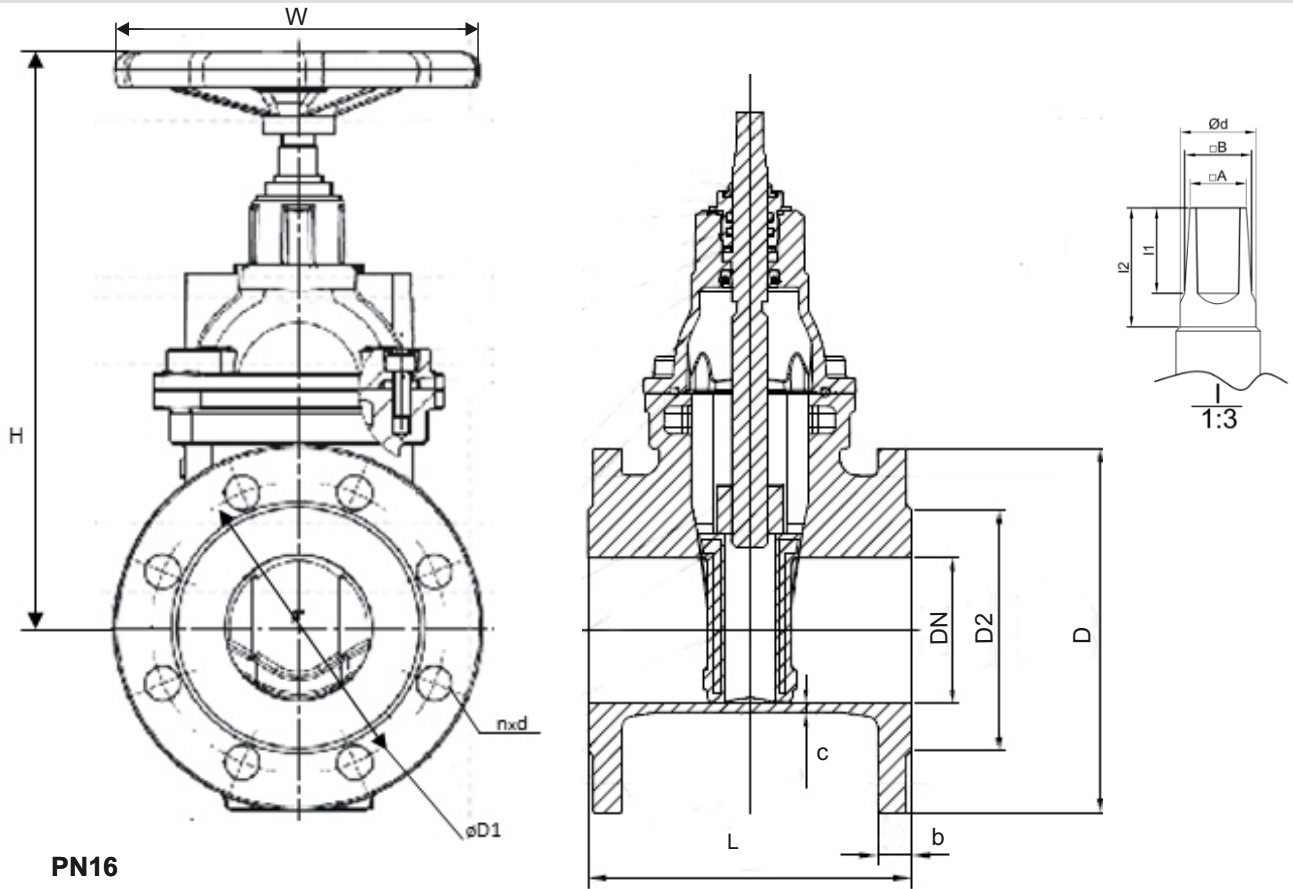

**PN16**

DN	H	L	D	D1	D2	b	n	d	W	C	A	B	Φd	I1	I2	kg
40	235	140	150	110	84	19	4	19	160	5,0	12,8	13,8	17	20	28	8,0
50	240	150	165	125	99	19	4	19	160	5,0	12,8	13,8	17	20	28	9,0
65	250	170	185	145	118	19	4	19	160	5,0	12,8	13,8	17	20	28	11,8
80	312	180	200	160	132	19	8	19	200	5,0	14,5	15,6	18	22	27	14,2
100	335	190	220	180	156	19	8	19	250	6,0	17,0	19,5	24	25	32	18,6
125	385	200	250	210	184	19	8	19	250	6,0	17,2	19,7	24	25	32	26,6
150	438	210	285	240	211	19	8	23	320	7,0	18,7	21,7	24	30	40	36,2
200	543	230	340	295	266	20	12	23	320	7,5	20,0	22,0	26	30	40	58,4
250	645	250	405	355	319	22	12	28	320	9,0	20,0	22,0	26	30	40	85,4
300	728	270	460	410	370	24,5	12	28	360	10,0	20,0	22,0	28	30	40	132,0

DN	H	L	D	D1	D2	b	n	d	W	C	A	B	Φd	I1	I2	kg
200	543	230	340	295	266	20	8	23	320	7,5	20,0	22,0	26	30	40	58,0
250	645	250	350	350	319	22	12	23	320	9,0	20,0	22,0	26	30	40	85,0
300	728	270	445	400	370	24,5	12	23	360	10,0	20,0	22,0	28	30	40	131,0

Data given can be changed without notice.

Edition 12/2016



**DIMENSION**

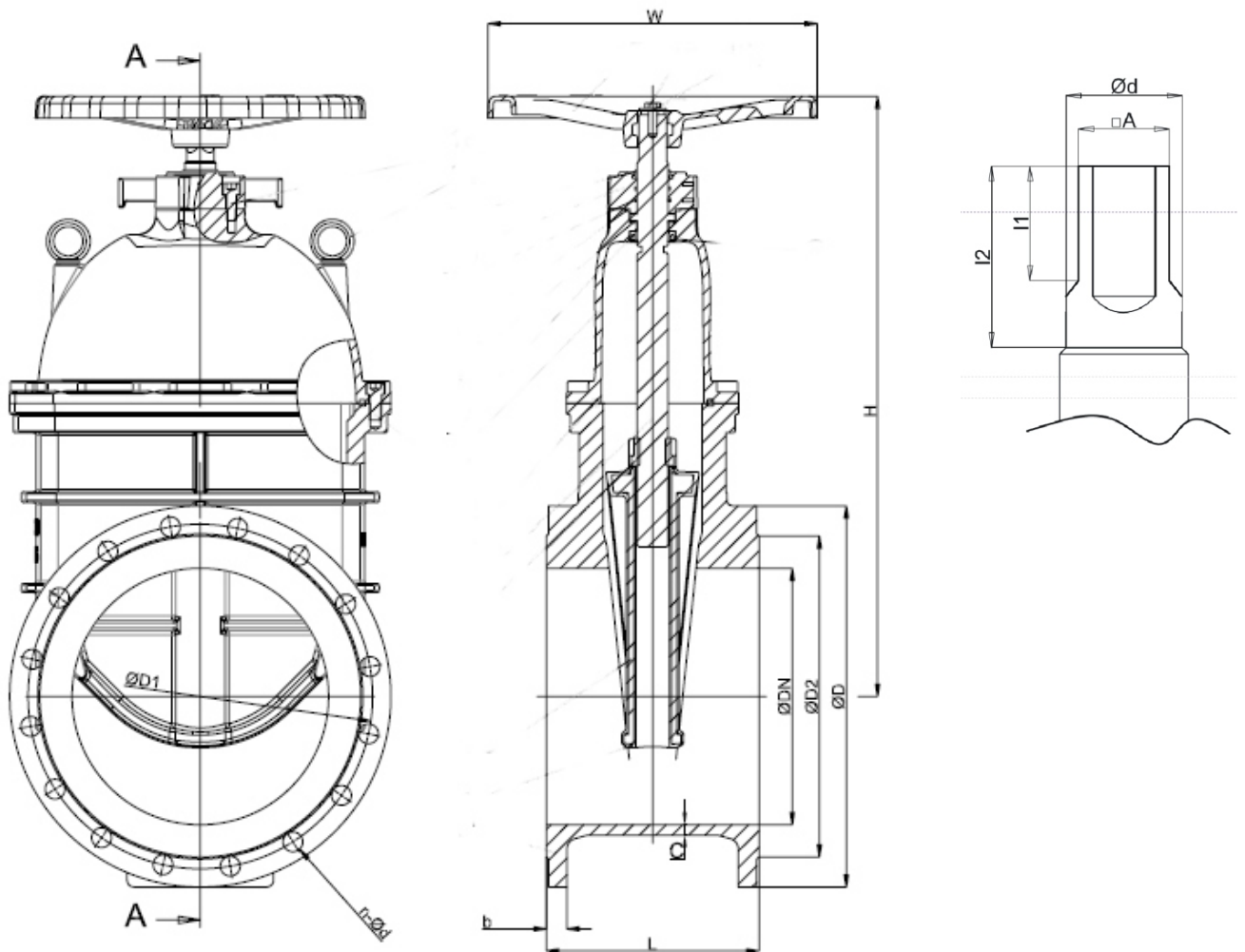

**PN16**

DN	H	L	D	D1	D2	b	n	d	W	C	□A	Φ d	l1	l2	kg
350	812	290	520	470	429	26,5	16	28	600	14	30,0	38	45	66	182,6
400	923	310	580	525	480	28,0	16	31	600	16	30,0	38	45	60	262,4
450	974	330	640	585	548	30,0	20	31	600	17	35,0	42	45	130	320,0
500	1073	350	715	650	609	31,5	20	34	730	18	35,0	45	45	60	400,0
600	1254	390	840	770	720	36,0	20	37	730	18	35,0	45	45	60	630,0

**PN10**

DN	H	L	D	D1	D2	b	n	d	W	C	□A	Φ d	l1	l2	kg
350	812	290	505	460	429	24,5	16	23	600	14	30,0	38	45	66	182,6
400	923	310	565	515	480	24,5	16	28	600	16	30,0	38	45	60	262,4
450	974	330	615	565	548	25,5	20	28	600	17	35,0	42	45	130	320,0
500	1073	350	670	620	609	26,5	20	28	730	18	35,0	45	45	60	400,0
600	1254	390	780	725	720	30,0	20	31	730	18	35,0	45	45	60	630,0

Data given can be changed without notice.

Edition 12/2016



**DIMENSIONS**

**Wykonanie 36-Y**

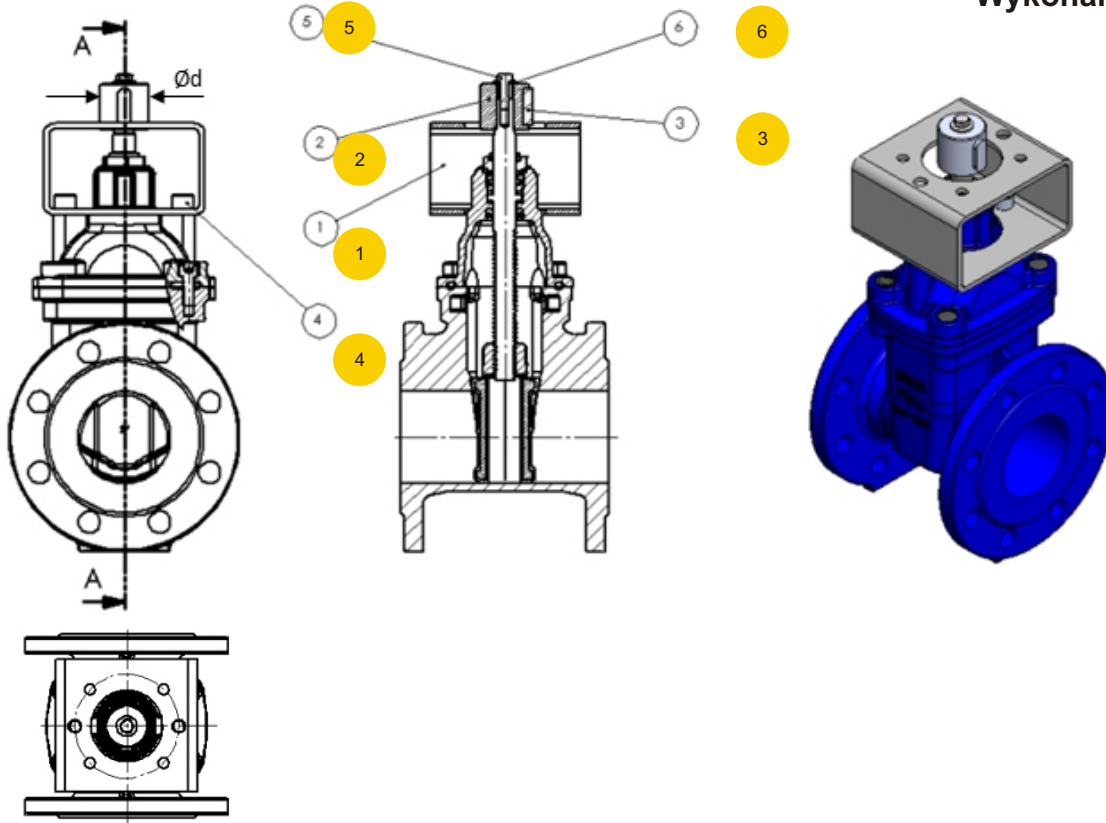

**The dimensions and the list of the main elements for mounting the actuator**

DN	40	50	65	80	100	125	150	200	250	300	List of parts
Bracket. Drilling acc. ISO 5210	F10	F10	F10	F10	F10	F10	F10	F10	F14	F14	1
Joint acc. ISO 5210 / B1 Ød mm	42	42	42	42	42	42	42	42	60	60	2
Parallel key	12x8x32	12x8x32	12x8x32	12x8x32	12x8x32	12x8x32	12x8x32	12x8x32	18x11x50	18x11x50	3
Bolt EN ISO 4762	2szt. M12x16 8.8	2szt. M12x16 8.8	2szt. M12x16 8.8	2szt. M12x16 8.8	2szt. M12x16 8.8	4szt. M10x16 8.8	4szt. M10x16 8.8	4szt. M10x16 8.8	4szt. M16x18 8.8	4szt. M16x18 8.8	4
Bolt EN ISO 4017	M8x35	M8x35	M8x35	M8x35	M10x35	M10x35	M10x35	M10x35	M12x50	M12x50	5
Pillow ISO 7094	M8	M8	M8	M8	M8	M10	M10	M10	M12	M12	6
Operating torque Nm	12	25	30	50	55	60	80	110	150	200	
Number of turns to complete closure	13	19	19	26	25	32	33	44	55	53	

Data given can be changed without notice.

Edition 12/2016



## DIMENSIONS

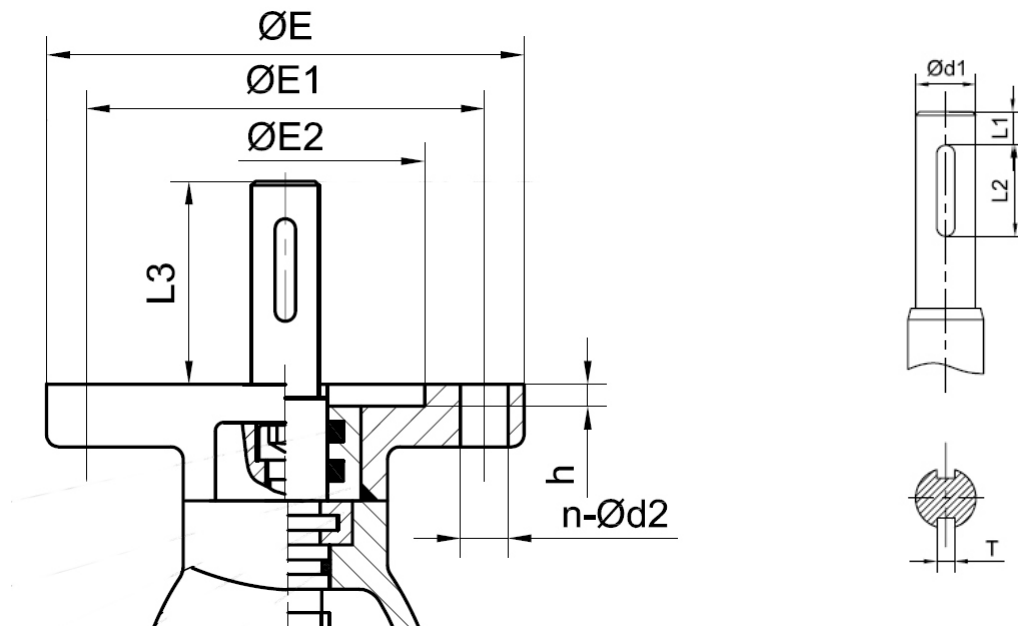

DN	Top Flange	ØE	ØE1	ØE2	h	n-Ød2	Ød1	L3	L1	T	L2
350	F14	175	140	100	4,5	4-18	30	65	5	8	60
400	F14	175	140	100	4,5	4-18	30	65	5	8	60
450	F14	175	140	100	4,5	4-18	30	65	5	8	60
500	F14	175	140	100	4,5	4-18	30	65	5	8	60
600	F14	175	140	100	4,5	4-18	30	65	5	8	60
700	F16	210	165	130	5,5	4-22	40	80	5	12	63
800	F25	300	254	200	5,5	8-18	50	100	10	14	70

### Moment zamknięcia

DN	350	400	450	500	600	700	800
Nm	370	430	470	500	600	800	1200

### Ilość obrotów do pełnego zamknięcia

DN	350	400	450	500	600	700	800
obroty	30	35	40	45	50	50	57

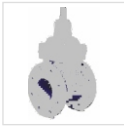
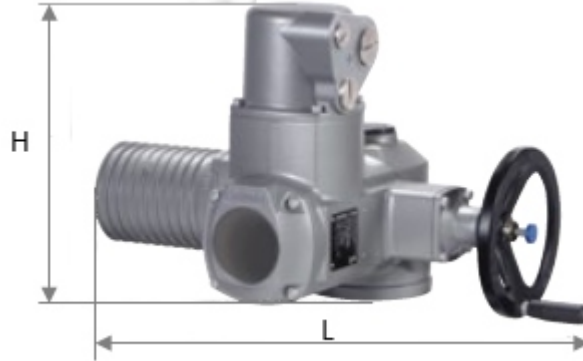

figure	111
ends form	flanged straight

## AUMA ACTUATOR



DN	PN	Type of AUMA	Torque Nm	Connection acc EN ISO 5210	L	H	Weight kg
40-50	16	SA 07.2	10 - 30	F10	514	288	19
65-100		SA 07.6	20 - 60	F10	514	288	21
125-200		SA 10.2	40 - 120	F10	536	290	23,5
250-300		SA 14.2	100 - 250	F14	725	316	48
350-600		SA 14.6	260 - 500	F14	728	316	53
700		SA 16.2	450 - 1000	F16	795	430	83
800		SA 25.1	1100 - 2000	F25	922	581	152

### Standard:

- Power supply - 400V
- Limit switches
- Overload protection
- Electomechanical Control Unit
- Thermal protection
- Thermostats
- Handwheel for manual operation





figure	<b>111</b>
ends form	flanged straight

## TYPES

figure	body material	nominal diameter DN	nominal pressure PN	type
111	D nodular cast iron EN-GJS-500-7	40-300 mm	C 16bar	57-Y Tmax 70 °C inside threaded stem · smooth port · EPDM · cast iron/EPDM wedge · epoxy paint · with hand wheel · universal cover
		40-800 mm	C 16 bar	36-Y Tmax 70 °C inside threaded stem · smooth port · EPDM · cast iron/EPDM wedge · epoxy paint · with hand wheel · Cover prepared for mounting the actuator
		40-300 mm	B 10bar	57-Y Tmax 70 °C inside threaded stem · smooth port · EPDM · cast iron/EPDM wedge · epoxy paint · with hand wheel · universal cover
		40-800 mm	B 10 bar	36-Y Tmax 70 °C inside threaded stem · smooth port · EPDM · cast iron/EPDM wedge · epoxy paint · with hand wheel · Cover prepared for mounting the actuator

## ORDERING

To place an order please use our product number (index)

figure	body material	nominal diameter DN	nominal pressure PN	type
111	D	040	C	56-Y

### ORDER EXAMPLE

gate valves, ends flange, form straight	111	D	040	C	57-Y
nodular cast iron EN-GJS-500-7		D			
nominal diameter DN40		040			
nominal pressure PN16			C		
inside threaded stem, universal cover, smooth port, cast iron/EPDM wedge · epoxy paint · with hand wheel					57-Y

Data given can be changed without notice.

Edition 12/2016